

11/07/16 4:12:40 PM THINK Christine Goso

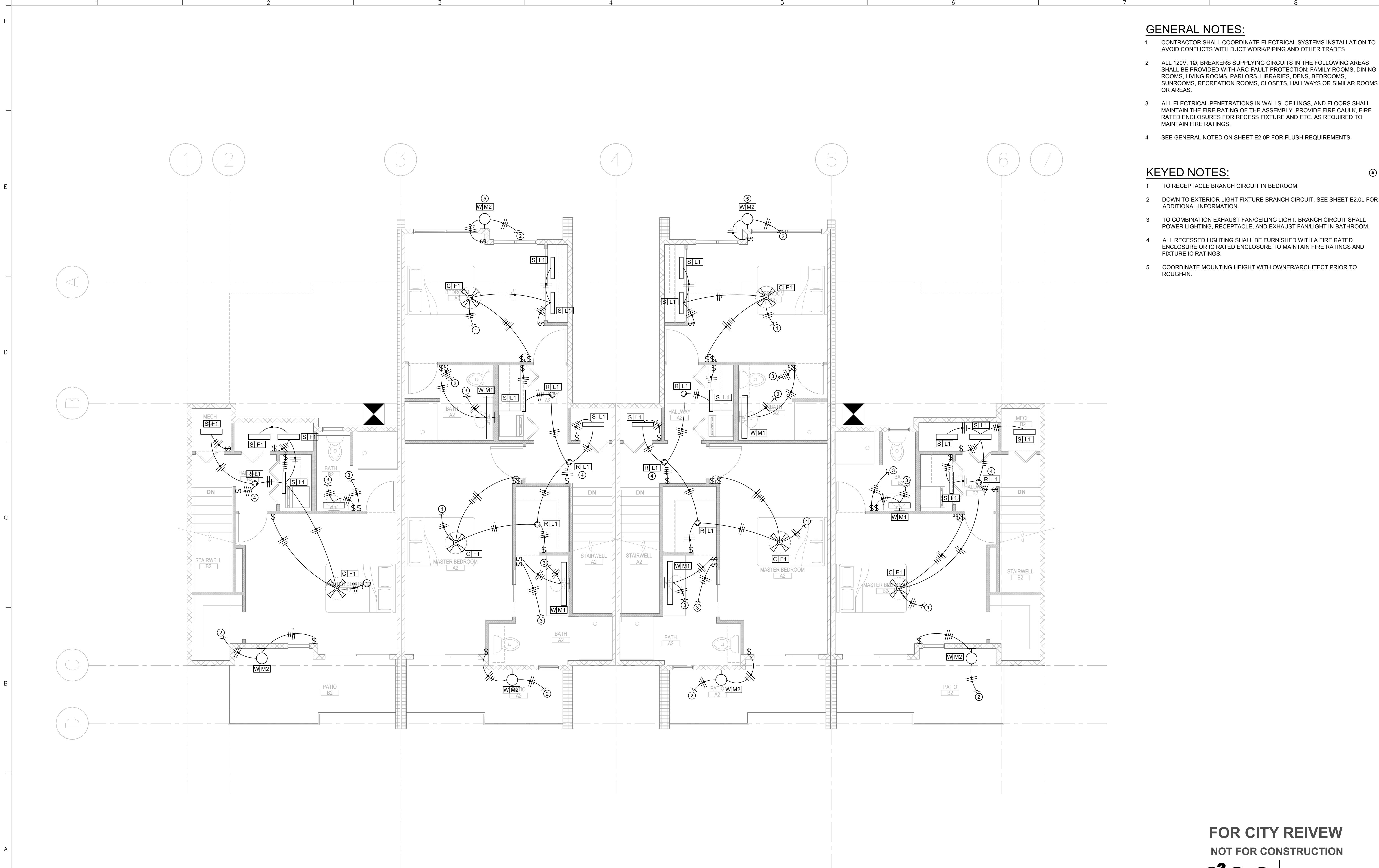

**SECOND FLOOR LIGHTING PLAN**  
 SCALE: 1/4" = 1'-0"

**GENERAL NOTES:**

- 1 CONTRACTOR SHALL COORDINATE ELECTRICAL SYSTEMS INSTALLATION TO AVOID CONFLICTS WITH DUCT WORK/PIPING AND OTHER TRADES
- 2 ALL 120V, 1Ø, BREAKERS SUPPLYING CIRCUITS IN THE FOLLOWING AREAS SHALL BE PROVIDED WITH ARC-FAULT PROTECTION; FAMILY ROOMS, DINING ROOMS, LIVING ROOMS, PARLORS, LIBRARIES, DENS, BEDROOMS, SUNROOMS, RECREATION ROOMS, CLOSETS, HALLWAYS OR SIMILAR ROOMS OR AREAS.
- 3 ALL ELECTRICAL PENETRATIONS IN WALLS, CEILINGS, AND FLOORS SHALL MAINTAIN THE FIRE RATING OF THE ASSEMBLY. PROVIDE FIRE CAULK, FIRE RATED ENCLOSURES FOR RECESS FIXTURE AND ETC. AS REQUIRED TO MAINTAIN FIRE RATINGS.
- 4 SEE GENERAL NOTED ON SHEET E2.0P FOR FLUSH REQUIREMENTS.

**KEYED NOTES:**

- 1 TO RECEPTACLE BRANCH CIRCUIT IN BEDROOM.
- 2 DOWN TO EXTERIOR LIGHT FIXTURE BRANCH CIRCUIT. SEE SHEET E2.0L FOR ADDITIONAL INFORMATION.
- 3 TO COMBINATION EXHAUST FAN/CEILING LIGHT. BRANCH CIRCUIT SHALL POWER LIGHTING, RECEPTACLE, AND EXHAUST FAN/LIGHT IN BATHROOM.
- 4 ALL RECESSED LIGHTING SHALL BE FURNISHED WITH A FIRE RATED ENCLOSURE OR IC RATED ENCLOSURE TO MAINTAIN FIRE RATINGS AND FIXTURE IC RATINGS.
- 5 COORDINATE MOUNTING HEIGHT WITH OWNER/ARCHITECT PRIOR TO ROUGH-IN.



405 S. 8th St, Suite 290  
 Boise, Idaho 83702  
 p: 208.685.2855  
 f: 208.685.2857  
 info@think-arch.com

NEW DEVELOPMENT  
**THE 27 ELM**  
 A HUNTER RENAISSANCE DEVELOPMENT  
 REDMOND OREGON

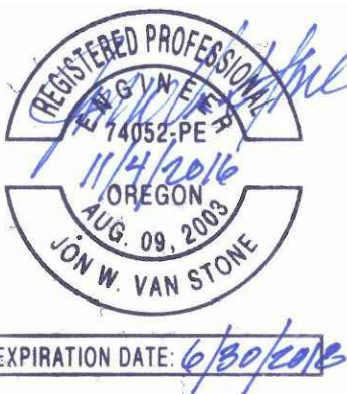

**COVER SHEET**  
 Sheet Title  
**AS NOTED**  
 Scale  
**1602**  
 Project Number  
**NOVEMBER 8, 2016**  
 Date  
**16154 E2LDWG**  
 File Name

**FOR CITY REVIEW  
 NOT FOR CONSTRUCTION**

**e2co** electricalengineeringcompany  
 engineering 4 tomorrow  
 world wide web: e2co.com  
 800 s. industry way, suite 350  
 meridian, idaho 83642  
 phone: 208.378.4450  
 fax: 208.378.4451  
 e2co project #: 16154

Revisions  
**E2.1L**